

# MASTER 4000

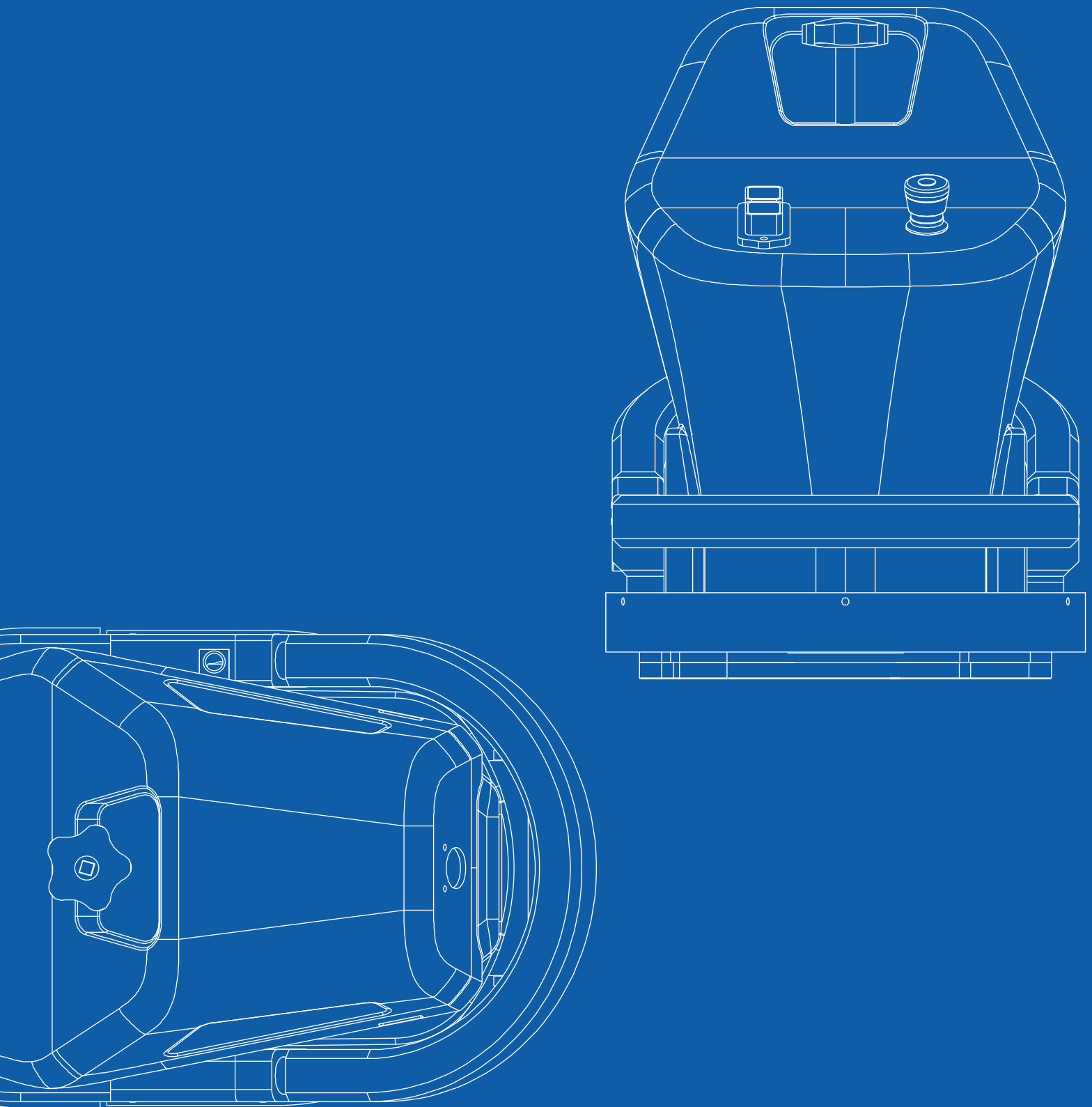





We proudly represent one of the leading Italian companies in the metal-mechanical sector, specializing in manufacturing diamond tools, machines and plants for processing ceramic, natural and synthetic stone.

Internationally acclaimed, we boast the highest number of patents, utility models, and industrial designs in the stone industry, filed, extended, and confirmed on a global scale.



# MASTER 4000

## Innovation and Tradition in Stone Processing

The **MASTER 4000** is a solid and robust manual machine designed for stone processing.

With just a few simple adjustments, it is ideal for shaping profiles quickly and efficiently.





# Why process with MASTER 4000?

The **MASTER 4000** is the choice of professionals seeking a portable shaping machine that makes the stone processing fast, practical, and easy.

**Profiling**



▶ The **MASTER 4000** manual contouring machine offers manufacturers the ability to work with any material in complex shapes, providing a high-quality product and significant time savings.



# Main functions



## Manual Z-Axis Adjustment

The manual adjustment of the tool on the Z-axis via the practical knob makes the Master 4000 suitable for various types of work.



## Start - Stop

To start and finish the processing easily and safely.



## Safety Button

Safety in the workshop is paramount, and the **MASTER 4000** is designed with the operator's peace of mind in mind. The Emergency Stop Button of the **MASTER 4000** is large and highly visible, to ensure optimal visibility in any situation.



## Water System Plate

The Water System Plate is designed to enhance performance by allowing it to glide over a thin film of water. This unique feature ensures exceptionally smooth operation, preventing scratches on the surfaces of the materials being processed.



- Smooth Operation**  
The water film between the machine and the material ensures that the Master 4000 moves effortlessly, reducing friction and preventing scratches on delicate surfaces.
- Unique Design**  
Developed by Marmoelettromeccanica, this system is considered the best on the market. Its design not only improves operational fluidity but also contributes to the overall efficiency of the Master 4000.
- Reliability and Durability**  
The Water System Plate is built to last. It does not clog or stop, ensuring continuous operation and long-lasting performance.





## Safety and Efficiency at Low Voltage

MASTER 4000 is designed to ensure maximum safety in any work environment, thanks to the CLASS A RAINPROOF GFCI (Ground Fault Circuit Interrupter) device that protects operators from electrical faults, especially in wet conditions.

Depending on the customer's requirements, the machine can operate at 110V or 220V, with either 50Hz or 60Hz frequency, ensuring versatility for various applications.

MASTER 4000 combines advanced technology with uncompromised safety, setting new standards in the industry for operator protection and operational effectiveness.



### Ideal for Wet Environments

Its compatibility with wet environments makes it the ideal choice for sectors such as marble processing and other applications that require the presence of water during the process.



### The Safest Machine in its Category

Thanks to advanced and other integrated safety measures, the MASTER 4000 is considered the safest machine in the world in its category, offering complete peace of mind to operators.

## Protection and Efficiency



**CLASS A RAINPROOF GFCI Ground  
Fault Circuit Interrupter**

This machine is designed to operate at a single, exclusive voltage: it can be either 110 volts or 220 volts. This means it is monotension and must be selected according to the specific power supply available.

This ensures compatibility with the intended workshop or construction site without the need for special adapters or transformers.

The **MASTER 4000** combines excellent power and operational flexibility, setting new standards of versatility and reliability in its field, and ensuring high-performance levels in every usage condition.

**PERSONAL PROTECTION INTERMEDIATE SWITCH** A safety device against electric shocks, equipped with undervoltage release and a response time of less than 30 ms. It detects faults and immediately cuts off the power supply.

This is the GFCI device, which supports 20 A at 110 V and 15 A at 250 V. Both versions are compatible with cables up to 3G2.5 mm<sup>2</sup> and provide IP66 protection.



### Dual Voltage Option

With the ability to function at both 110 volts and 220 volts, the machine offers unprecedented flexibility, easily adapting to both small artisan workshops and large industrial sites.



### Guaranteed Power

A consumption of 1500W for 220 volts and 14Ah for 110 volts ensures that the machine has the necessary power for heavy and continuous operations, maintaining high standards of efficiency and productivity.



### Ideal for Any Environment

Once it leaves the factory, the machine is configured to operate at a single, predetermined voltage and cannot be used at different voltages. This means it must be selected according to the specific power supply available, limiting its use to the voltage specified at the time of manufacture.

## MASTER 4000: Built to Last

The **MASTER 4000** is entirely constructed from stainless steel and aluminum, materials chosen to ensure maximum durability and resistance over time. This combination also provides superior resistance to corrosion, wear, and environmental stress.

Previous versions of the Master have proven their reliability and longevity, with machines still operational after more than 30 years of intensive service. This impressive track record is a testament to the outstanding quality and longevity of the Master machines.

The **MASTER 4000** reduces the need for maintenance and replacement. It is ideal for those looking for a reliable product that will ensure excellent performance for decades

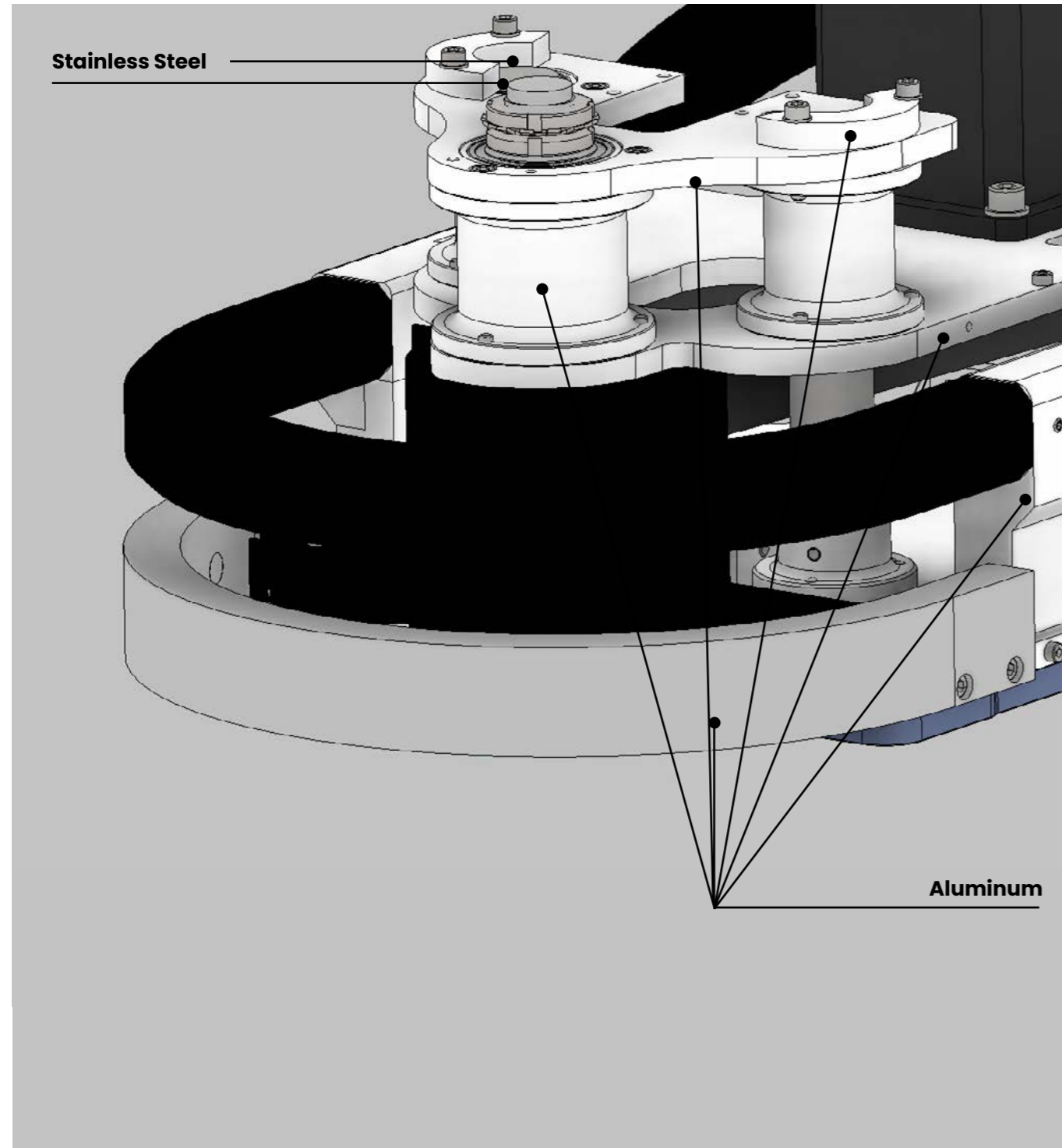

## High-Efficiency Motor and Superior Performance

The **MASTER 4000** is equipped with a monophase motor, a technological choice that enhances both efficiency and ease of use. This single-phase motor is designed to deliver consistent power while simplifying installation and maintenance.

With this advanced motor, the **MASTER 4000** represents the pinnacle of mechanical and electrical efficiency, providing superior performance and lower operating costs, making every task simpler and more productive.



### Energy Efficiency

These motors are designed to optimize energy consumption while delivering consistent performance.



### Increased Durability

The single-phase motor's simplified design increases lifespan, requiring less maintenance and fewer replacements.



### Enhanced Performance

The single-phase motor delivers consistent power at all speeds, ensuring maximum performance.



### Reliability

With fewer mechanical components, the single-phase motor offers greater reliability and consistent performance, even under heavy loads.

## MASTER 4000

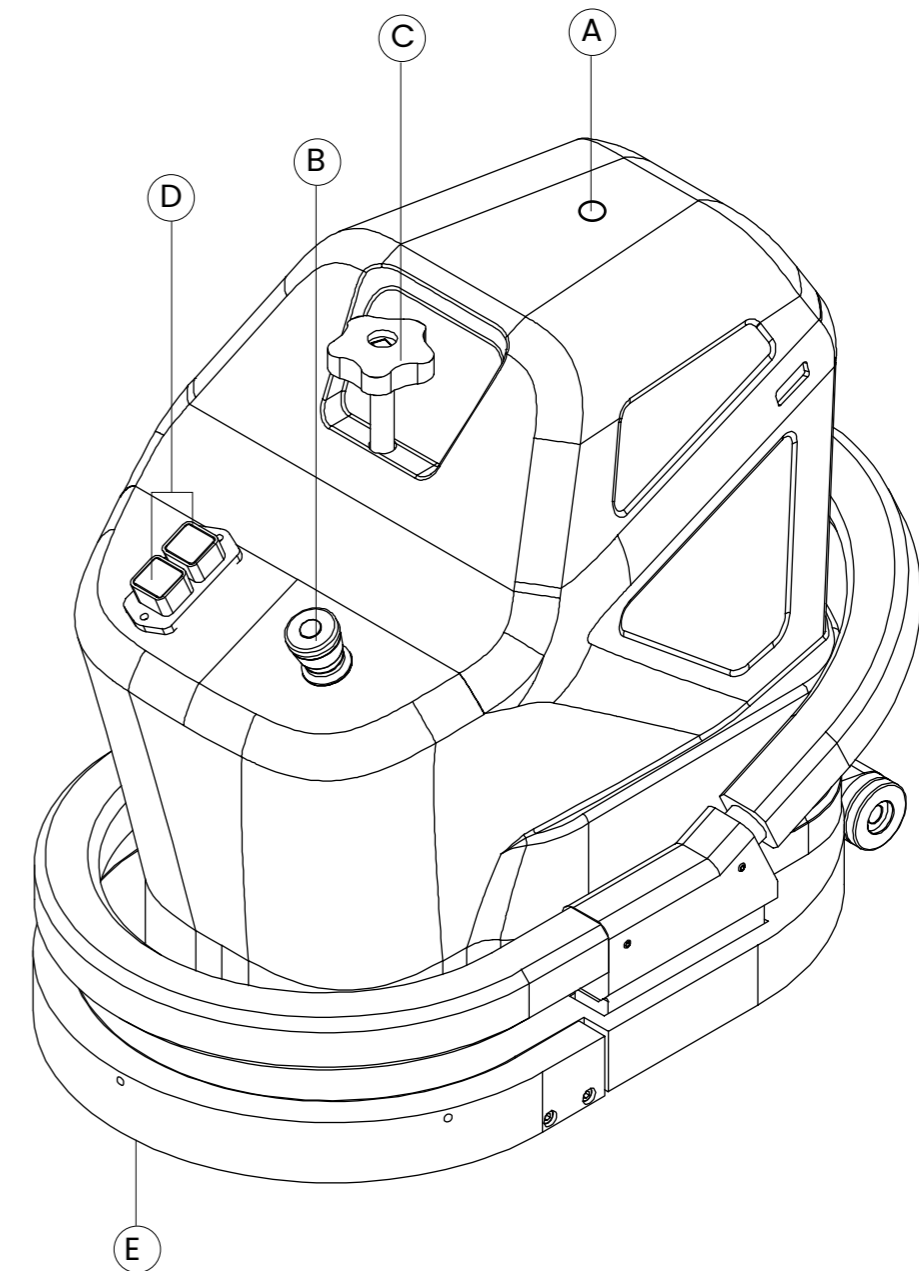
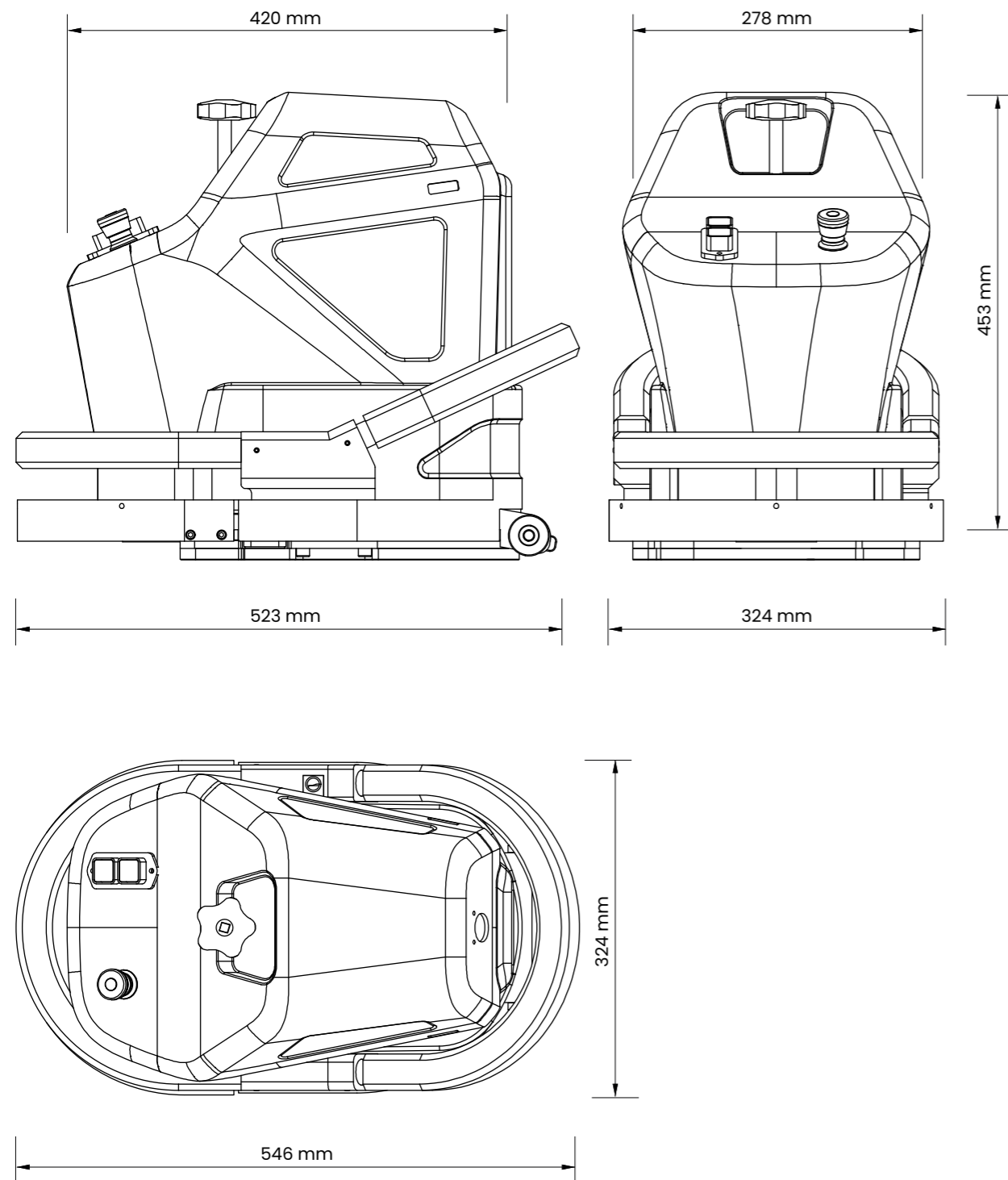

**A- Electrical cable.** The current has to travel 6 metres; the cable must always be connected to the central conversion unit by a special plug.

**B- Stop button.** Red stop switch is marked with "OFF" gives you the possibility to quickly turn off the machine even in an emergency.

**C - Knob Z-Axis.** The manual adjustment of the tool on the Z-axis via the practical knob makes the Master 4000 suitable for various types of work.

**D - Start and Stop.** Buttons to start and finish the processing easily and safely.

**E- Water spray system.** The machine is equipped with 4 adjustable water jets and a system for washing the surface which ensures that the bits cool down and that dust does not build up.

# Technical Data



## MASTER 4000

<b>SHAFT SPEED</b>	RPM 6000
<b>MECHANICAL STRUCTURE</b>	Aluminum Stainless Steel
<b>MOTOR</b>	1,6 kW 110V 60Hz 1,5 kW 220V 50Hz 1,5 kW 110V 50Hz
<b>HOUSING</b>	MDPE
<b>SPECIAL TREATMENT</b>	Mechanical part: Anticorodal Aesthetic part: Heat painted
<b>TRASMISSION</b>	Poly/v 12J
<b>MANUAL TOOL ADJUSTMENT</b>	0 - 60mm

# Packaging

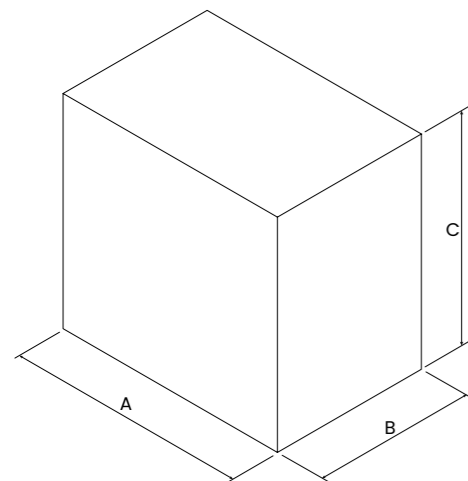

<b>MASTER 4000</b>	
<b>A</b>	610 mm
<b>B</b>	410 mm
<b>C</b>	580 mm
<b>Weight</b>	35 kg



